

FINISH LEGEND

FLOORING

VINYL COMPOSITION TILE

- VCT-1 MANUFACTURER: ARMSTRONG PATTERN: IMPERIAL TEXTURE COLOR: FIELD GRAY - 51927 SIZE: 12" x 12" DESCRIPTION: FIELD - SEE PLAN

CARPET TILE

- CT-1 MANUFACTURER: MANNINGTON COMMERCIAL COLLECTION: DARK SKIES PATTERN: COAST COLOR: VISTA SIZE: 12" x 24" INSTALLATION PATTERN: VERTICAL ASHLAR COLLECTION: OFFICES - SEE PLAN

6" ROLL HYBRID RESILIENT CARPET

- BC-1 MANUFACTURER: TARKETT PRODUCT: POWERBOND ROLL PRODUCT: CARTOGRAPHY 0843 COLOR: MINTED 15605 SIZE: 6" ROLL, WELDED SEAMS DESCRIPTION: AUDITORIUM - SEE PLAN

SPORT RESILIENT FLOOR

- SRF-1 MANUFACTURER: CONNOR SPORTS PRODUCT: ELASTIPLUS COLOR: TBD DESCRIPTION: BASE BID GYM FLOOR PROVIDE 3 COLORS FOR COURT STRIPING PER A-441 (SRF-A, B & C)

RUBBER TILE FLOOR

STAGE FLOOR

- SF-1 MANUFACTURER: ROBBINS PRODUCT: BID CHANNEL CLASSIC COLOR: SELECT FROM MFR STANDARD DESCRIPTION: STAGE - SEE PLAN WOOD FLOOR WITH HARD BD. FINISH

SEALED CONCRETE FLOOR

- SC-1 MANUFACTURER: TDB COLOR: TRANSPARENT NUMBER: TBD DESCRIPTION: SERVICE SPACES

MOSAIC FLOOR TILE

- MT-1 MANUFACTURER: CROSSVILLE PATTERN: MAIN STREET COLOR: TBD SIZE: 2" x 2" DESCRIPTION: SHOWER MOSAIC TILE

SHEET VINYL

- SV-1 MANUFACTURER: ARMSTRONG PATTERN: MEDINTONE COLOR: TBD SIZE: 6" ROLL DESCRIPTION: FIELD - SEE PLAN

WALK-OFF CARPET

WALK-OFF CARPET TILE

- WCT-1 MANUFACTURER: MANNINGTON PATTERN: INERTIA COLOR: STATIC COLOR: TBD SIZE: 18" x 36" DESCRIPTION: SEE FINISH SCHEDULE

PORCELAIN FLOOR TILE

- PFT-1 MANUFACTURER: CROSSVILLE PATTERN: GOTHAM COLOR: LAMP POST SIZE: 12" x 24" DESCRIPTION: LARGE FORMAT TILE

STAIR COVERINGS

PRECAST CONCRETE STAIR TREADS

- PCT-1 MANUFACTURER: CAMP LOGAN CEMENT WORKS, INC. COLOR: WHITE TO BE SELECTED FROM MFR RANGE DESCRIPTION: SEE FINISH SCHEDULE STAIRS A, B, AND C INCLUDE SEALANT

GROUT

- GT-1 MANUFACTURER: MAPEI COLOR: TBD NUMBER: TBD DESCRIPTION: TYPICAL GROUT

WALL BASE

4" RUBBER COVE BASE

- RB-1 MANUFACTURER: JOHNSONITE COLOR: TBD NUMBER: TBD DESCRIPTION: @ VCT/LVT/TCT

RESINOUS FLOOR

- RF-1 MANUFACTURER: STONHARD PRODUCT: STONES RTZ COLOR: WHITE/OFF WHITE DESCRIPTION: BASE BID CAFETERIA

RESINOUS BASE

- RSB-1 MANUFACTURER: STONHARD PRODUCT: STONTEG COLOR: USE ADJACENT FLOOR COLOR DESCRIPTION: FLASH COVE @ RESINOUS FLOORING

TEXTILE COMPOSITION TILE

- TCT-1 MANUFACTURER: J + J KINETEX PATTERN: ANALOG MONO 1822 COLOR: LINK 1553 SIZE: 24" x 24" DESCRIPTION: COMMONS - SEE PLAN

THRESHOLDS

MARBLE

- TR2 MANUFACTURER: TDB PATTERN: TBD COLOR: TBD SIZE: TBD DESCRIPTION: AT TOILET ROOMS

WALL FINISH

PAINT

- P-1 MANUFACTURER: SHERWIN WILLIAMS COLOR: ROMAN COLUMN NUMBER: SW 7562 DESCRIPTION: TYPICAL WALL

VINYL WALL COVERING

- VWC-1 MANUFACTURER: EFKON PATTERN: CUSTOM DIGITAL DESCRIPTION: MEDIA CENTER SOFFIT - SEE PLAN

PORCELAIN WALL TILE

- PWT-1 MANUFACTURER: CROSSVILLE PATTERN: GOTHAM COLOR: LAMP POST SIZE: 12" x 24" DESCRIPTION: LARGE FORMAT TILE

NOTE: PROVIDE BRUSHED STAINLESS STEEL SCHLUTER-DILEX-EHK AT FLOOR TILE TO WALL JOINTS. PROVIDE BRUSHED STAINLESS STEEL SCHLUTER-SCHIENE EDGE PROTECTION AT ALL OUTSIDE CORNERS. PROVIDE BRUSHED STAINLESS STEEL SCHLUTER-SCHIENE EDGE PROTECTION AT TOP OF WAINSCOT.

WALL PROTECTION

- WPM-1 MANUFACTURER: CONSTRUCTION SPECIALTIES PATTERN: TBD COLOR: TBD SIZE: TBD DESCRIPTION: THIRD FLR CORRIDOR ACCENT, SEE PLAN

CORNER GUARDS

- CG-1 MANUFACTURER: NOT IN USE COLOR: TBD DESCRIPTION: NOT IN USE

ACOUSTICAL WALL PANELS

- AWP-1 MANUFACTURER: ARMSTRONG TECTUM COLOR: SOFTENED GREEN NUMBER: SW 6177 DESCRIPTION: MEDIA CENTER AND SERVRY SOFFIT ACCENT, SEE PLAN

ACOUSTICAL WOOD PANELS

- WP-1 MANUFACTURER: KINETICS ALTO PANELS COLOR: TBD SPECIES: MARLE DESCRIPTION: CUSTOM PANELS AUDITORIUM

SKYFOLD PANELS

- SKY-1 MANUFACTURER: GUILFORD OF MAINE PATTERN: MARIN 1300 COLOR: BENTIC 1157 DESCRIPTION: SKYFOLD PANELS AUDITORIUM

CASEWORK

PLASTIC LAMINATE

- PL-1 MANUFACTURER: WILSONART PATTERN: MISSION MAPLE 7990-38 DESCRIPTION: TYPICAL, SEE PLAN

WOOD

BASIS OF DESIGN: TBD

ST-1 PATTERN: TDB DESCRIPTION: SCIENCE CLASSROOMS

SOLID SURFACE

- SS-1 MANUFACTURER: CORIAN COLOR: SEAGRASS DESCRIPTION: COUNTERTOPS & WINDOW SILLS

TOILET PARTITIONS

SOLID COLOR COMPOSITE

- TP-1 MANUFACTURER: SCRANTON PRODUCTS TYPE: HINY HIDERS, CLASS B COLOR: GRAY DESCRIPTION: CURTAIN ON TRACK WITH MESH AT TOP. SEE SPECIFICATIONS.

GENERAL FINISH NOTES

- A. ALL MATERIALS LISTED ON FINISH SCHEDULE ARE "BASIS OF DESIGN". REFER TO SPECIFICATION MANUAL FOR MANUFACTURER'S INFORMATION.

ABBREVIATIONS

- BC BROADLOOM CARPET CORNER GUARD

FINISH ALTERNATES

- A-5 TYPICAL FLOORS - ALTERNATE TO HAVE RUBBER FLOOR TILE IN PLACE OF VCT. THE FOLLOWING ROOMS TO REMAIN VCT:

RUBBER TILE FLOOR

- RT-1 MANUFACTURER: NORAPLAN PATTERN: ENVIRONCARE COLOR: CLAM BAKE NUMBER: 7036 LOCATION: ALTERNATE

A-6 STAIRS - STA. STB. SCT. - ALTERNATE

- TO HAVE THE FOLLOWING FINISHES: FLOOR: TRF-1, TRF-2, TRF-3, & TRF-5. REFER TO PATTERN PLANS ON H-11 AND H-12. ALL OTHER FINISHES PER BASE BID.

LUXURY VINYL TILE

- LVT-1 MANUFACTURER: TARKETT PRODUCT: ID LATTICE WOOD COLOR: BLANCHED PINE NUMBER: 5134 DESCRIPTION: ALTERNATE @ STAIR LANDINGS INCLUDE STAIR NOSING FOR TOP OF RUNS

A-7 CAFETERIA & CORRIDORS - B123, A1008 & A1006 - ALTERNATE

- TO HAVE TERRAZZO FLOOR. FLOOR: TRF-1, TRF-2, TRF-3, & TRF-5. REFER TO PATTERN PLANS ON H-11 AND H-12. BASE: TRB-1. ALL OTHER FINISHES PER BASE BID.

TERRAZZO

- TRF-1 MANUFACTURER: MASTER TERRAZZO PATTERN: TBD COLORS: WHITE / OFF WHITE SIZE: TBD DESCRIPTION: ALTERNATE CAFETERIA & CORRIDORS ACCENT COLOR - SEE PLAN

TERRAZZO BASE

- TRB-1 MANUFACTURER: TBD COLORS: USE ADJACENT FLOOR COLOR NUMBER: TBD DESCRIPTION: STRAIGHT PRECAST COVE @ TERRAZZO

A-8 SERVERY - B122 - ALTERNATE

- TO HAVE THE FOLLOWING FINISHES: FLOOR: TRF-4, BASE: TRB-1. ALL OTHER FINISHES PER BASE BID.

TERRAZZO

- TRF-4 MANUFACTURER: MASTER TERRAZZO PATTERN: TBD COLORS: WHITE/LIGHT RED SIZE: TBD DESCRIPTION: ALTERNATE SERVERY

TERRAZZO BASE

- TRB-1 MANUFACTURER: TBD COLORS: USE ADJACENT FLOOR COLOR NUMBER: TBD DESCRIPTION: STRAIGHT PRECAST COVE @ TERRAZZO

WOOD FLOOR

- WDF-1 MANUFACTURER: ROBBINS PRODUCT: BID CHANNEL CLASSIC COLOR: MAIN AND ACCENT STAINS DESCRIPTION: GYMNASIUM - SEE PLAN WOOD FLOOR WITH HARD BD. FINISH (SEE SPECIFICATIONS)

STEEL ANGLE BASE

- SB-1 MANUFACTURER: ROBBINS COLOR: TBD SIZE: #44 DESCRIPTION: ALTERNATE BASE @ GYM

SPORT WOOD STAIN

- SST-1 MANUFACTURER: TBD COLOR: TBD DESCRIPTION: ALTERNATE GYM FLOOR USE WITH WDF-1

SPORT PAINT

- SP-1 MANUFACTURER: TBD COLOR: BLACK DESCRIPTION: ALTERNATE GYM STRIPING

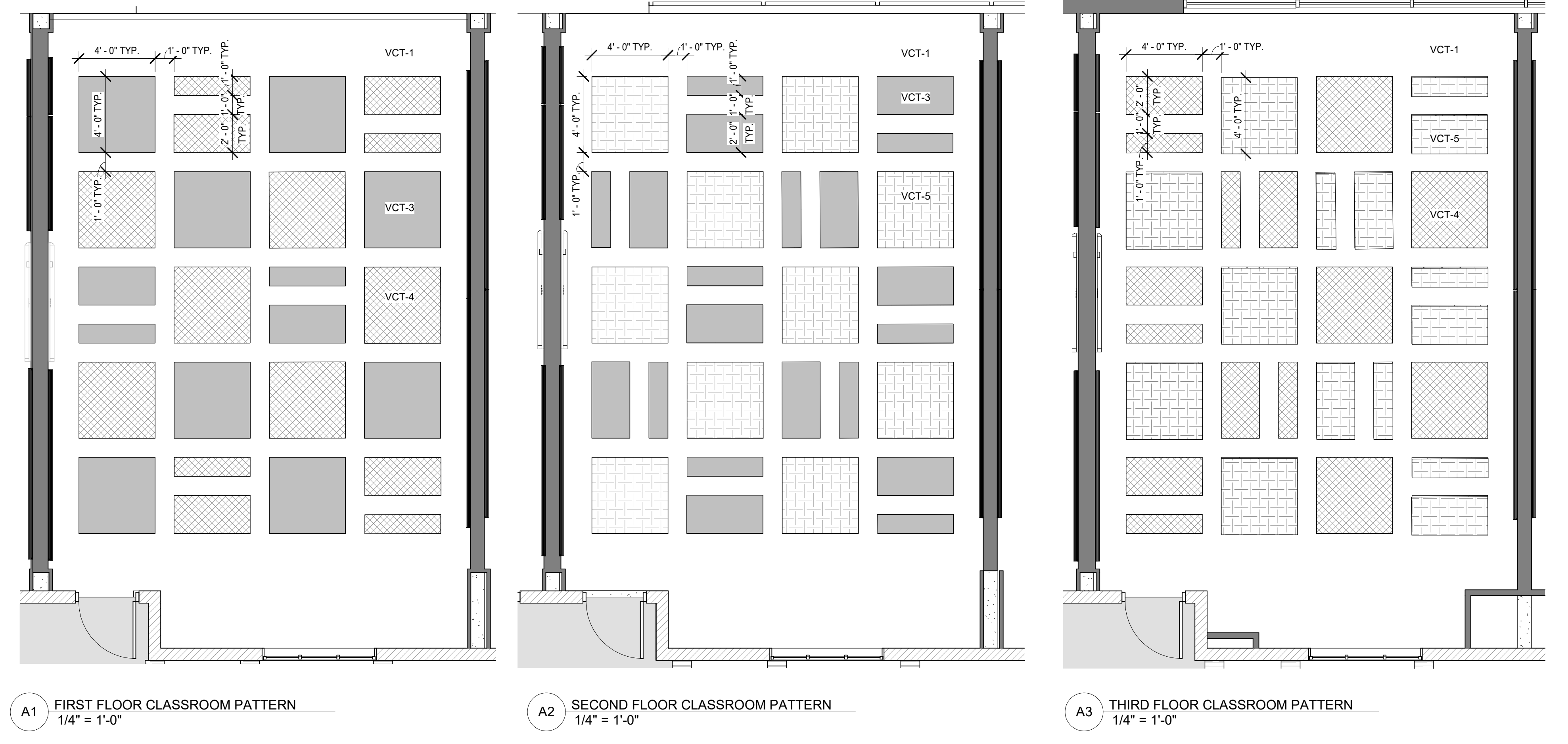

1621 N. Lincoln Street
Wilmington, DE 19806
(P) 302.658.6426
(F) 302.658.8431
abhagen@ABHA.com
www.ABHA.com

CONSULTANTS
Davis Bowen & Friedel, Inc.
Civil Engineer

Pilottown Engineering
Structural Engineer

Activitas, Inc.
Landscape Architect

GIPE Associates
MEP Engineer

Stages
Theater & Acoustic Consultant

Corsi Associates
Food Service Consultant

CONSTRUCTION DOCUMENTS

PROJECT
NEW MIDDLE SCHOOL

910 SHIELDS AVENUE
LEWES, DE 19958

OWNER
CAPE HENLOPEN
SCHOOL DISTRICT

1270 KINGS HWY
LEWES, DE 19585

KEYPLAN

Table with 4 columns: No., Date, Description, and Revision. Includes entries for ASI 008, Addendum No. 4, 3, and 2, and a Final Review.

PROJECT NUMBER: 2020-14
FILE NAME: CHMS_Arch_v2020.rvt
DRAWN BY: LR
CHECKED BY: BTW

The professional services of ABHA Architects, Inc. are undertaken for and performed in the interest of Cape Henlopen School District. No contractual obligation is assumed by ABHA Architects, Inc. for the benefit of any other person involved in the project.
These documents are owned by ABHA Architects, Inc. and shall not be used without written permission. Copyright ABHA Architects, Inc. © 2021

SHEET TITLE
FINISH LEGEND &
GENERAL NOTES

I-001