

1

2

3

4

5

6

E

D

C

B

A



1621 N. Lincoln Street
 Wilmington, DE 19806
 (P) 302 . 658 . 6426
 (F) 302 . 658 . 8431
 abhagen@ABHA.com
 www.ABHA.com

CONSULTANTS
 Davis Bowen & Friedel, Inc.
 Civil Engineer
 1 Park Avenue
 Wintrow, DE 19983

Pilotown Engineering
 Structural Engineer
 17285 Nassau Commons Blvd, Unit 3
 Lewes, DE 19958

Activitas, Inc.
 Landscape Architect
 70 Milton Street
 Dedham, MA 02026

GIPE Associates
 MEP Engineer
 8719 Brooks Drive
 Easton, MD 21601

Stages
 Theater & Acoustic Consultant
 732-333-8003

Corsi Associates
 Food Service Consultant
 1489 Baltimore Pike
 Springfield, PA 19064

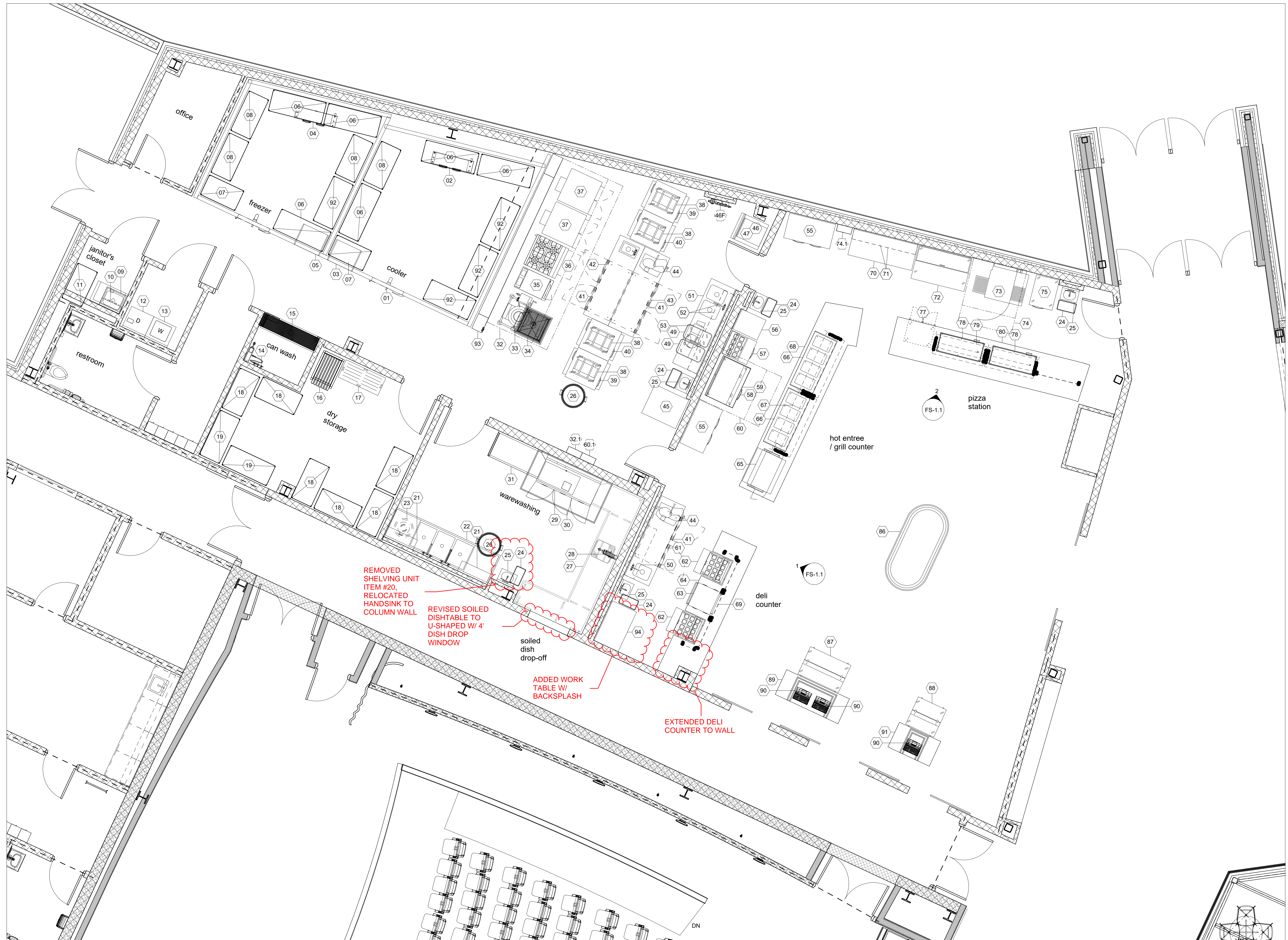

REMOVED
 SHELVING UNIT
 ITEM #20,
 RELOCATED
 HANDSINK TO
 COLUMN WALL

REVISED SOILED
 DISHTABLE TO
 U-SHAPED W/ 4'
 DISH DROP
 WINDOW

soiled
 dish
 drop-off

ADDED WORK
 TABLE W/
 BACKSPLASH

EXTENDED DELI
 COUNTER TO WALL

1 FOODSERVICE EQUIPMENT PLAN
 1/4" = 1'-0"

PROJECT
 NEW MIDDLE SCHOOL
 910 SHIELDS AVENUE
 LEWES, DE 19958

OWNER
 CAPE HENLOPEN
 SCHOOL DISTRICT
 1270 KINGS HWY
 LEWES, DE 19585

KEYPLAN

2	05/17/22	CONFORMED SET
1	03/18/22	ISSUED FOR BID
MARK	DATE	DESCRIPTION

PROJECT NUMBER: 2020-14
 FILE NAME: CHMS_Arch_v2020.rvt
 DRAWN BY: N. SAMON
 CHECKED BY: M. CORSI

The professional services of ABHA Architects, Inc. are undertaken for and performed in the interest of Cape Henlopen School District. No contractual obligation is assumed by ABHA Architects, Inc. for the benefit of any other person involved in the project.
 These documents are owned by ABHA Architects, Inc. and shall not be used without written permission. Copyright ABHA Architects, Inc. © 2021

SHEET TITLE
 FOODSERVICE EQUIPMENT
 PLAN

FS-1.0

1

2

3

4

5

6