

LEGEND

- NEW MTL STUD WALL CONSTRUCTION, SEE WALL PARTITION SCHEDULE FOR TYPE
- CMU PARTITION, SEE PARTITION SCHEDULE FOR TYPE
- NEW DOOR
- WALL TAG (SEE _____ FOR PARTITION SCHEDULE)
- STOREFRONT
- CURTAIN WALL
- WINDOW
- VISION PANEL
- MARKER BOARD / TACK BOARD TYPE

- ### FLOOR PLAN AND ENLARGEMENT KEYNOTES
- BALLISTIC FILM/GLAZING (H49)
 - CUSTOM RECEPTION DESK WITH SOLID SURFACE COUNTER AND TRANSACTION TOP, DECORATIVE PLASTIC LAMINATE FRONT, PLASTIC LAMINATE BASE.
 - DECORATIVE BACK-LIT ACRYLIC COMPONENT.
 - SINK IN PLASTIC LAMINATE ADA SINK BASE.
 - PLASTIC LAMINATE BASE AND WALL CABINETS; SOLID SURFACE COUNTERTOP.
 - SMARTBOARD
 - CUBICLE CURTAINS AND TRACK
 - ACCESS LADDER
 - BUILT-IN SOLID SURFACE BENCH
 - BUILT-IN DISPLAY CASE.
 - PLASTIC LAMINATE MAIL SLOTS (70)
 - SINK IN SCIENCE CASEWORK
 - SCIENCE CASEWORK
 - METAL LOCKER
 - CUSTOM CIRCULATION DESK WITH SOLID SURFACE TRANSACTION TOP, DECORATIVE PLASTIC LAMINATE FRONT, PLASTIC LAMINATE BASE CABINETS.
 - KILN
 - LIBRARY STACK SHELVING, N.I.C. - FOR REFERENCE ONLY
 - ACRYLIC SIGNAGE
 - MONITOR

- ### GENERAL SHEET NOTES
- VERIFY ALL DIMENSIONS AND CONDITIONS IN THE FIELD BEFORE PROCEEDING WITH WORK.
 - SEE A-001 FOR SYMBOLS AND ABBREVIATIONS
 - ALL MASONRY PARTITIONS ARE DIMENSIONED TO FACE OF PARTITION OR OPENING.
 - ALL INTERIOR STUD PARTITIONS ARE DIMENSIONED TO THE CENTERLINE OF STUD (UNLESS OTHERWISE NOTED).
 - EXTERIOR WALLS ARE DIMENSIONED TO THE OUTSIDE FACE (UNLESS OTHERWISE NOTED).
 - SEAL ALL PENETRATIONS THRU RATED PARTITIONS AND FLOOR SLABS WITH FIRE SAFING INSULATION AND SEALANT AS REQUIRED TO MAINTAIN RATED SEPARATION.
 - SEE G-SERIES CODE SHEETS FOR LOCATIONS OF RATED PARTITIONS AND SMOKE PARTITIONS.



1621 N. Lincoln Street
 Wilmington, DE 19806
 (P) 302.658.6426
 (F) 302.658.8431
 abhagen@ABHA.com
 www.ABHA.com

CONSULTANTS
 Davis Bowen & Friedel, Inc.
 Civil Engineer

Pilottown Engineering
 Structural Engineer

Activitas, Inc.
 Landscape Architect

GIPE Associates
 MEP Engineer

Stages
 Theater & Acoustic Consultant

Corsi Associates
 Food Service Consultant

CONSTRUCTION DOCUMENTS

PROJECT
 NEW MIDDLE SCHOOL

910 SHIELDS AVENUE
 LEWES, DE 19958

OWNER
 CAPE HENLOPEN
 SCHOOL DISTRICT
 1270 KINGS HWY
 LEWES, DE 19585

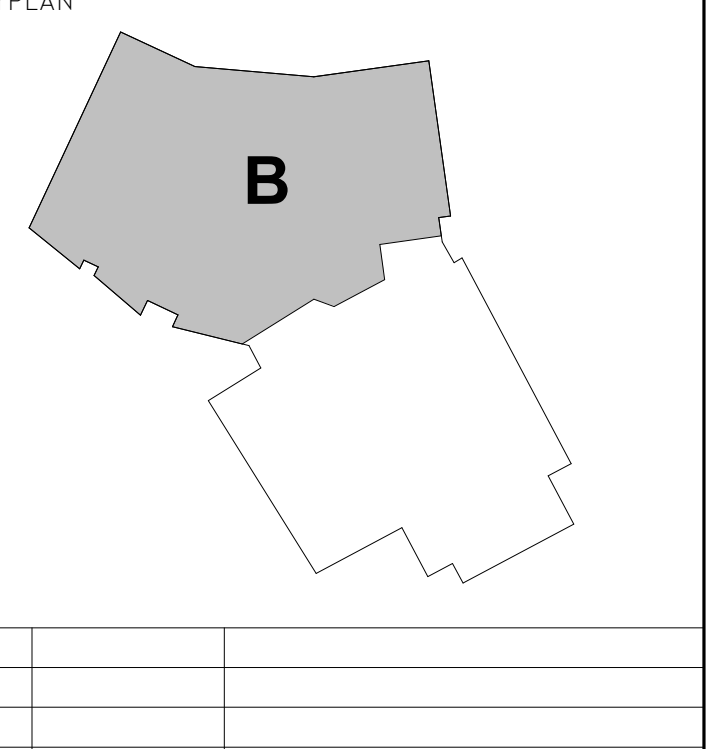

MARK	DATE	DESCRIPTION
6	11/17/2022	ASI 014
5	09/16/2022	ASI 006
4	04/20/2022	ADDENDUM NO. 3
3	05/17/2022	CONFORMANCE SET
2	03/18/2022	ISSUED FOR BID
1	02/04/2022	DFM FINAL REVIEW

PROJECT NUMBER: 2020-14
 FILE NAME: CHMS_Arch_v2020.rvt
 DRAWN BY: LR
 CHECKED BY: BTW

The professional services of ABHA Architects, Inc. are undertaken for and performed in the interest of Cape Henlopen School District. No contractual obligation is assumed by ABHA Architects, Inc. for the benefit of any other person involved in the project.

These documents are owned by ABHA Architects, Inc. and shall not be used without written permission. Copyright ABHA Architects, Inc. © 2021

SHEET TITLE
 THIRD FLOOR PLAN - AREA 'B'

A-132

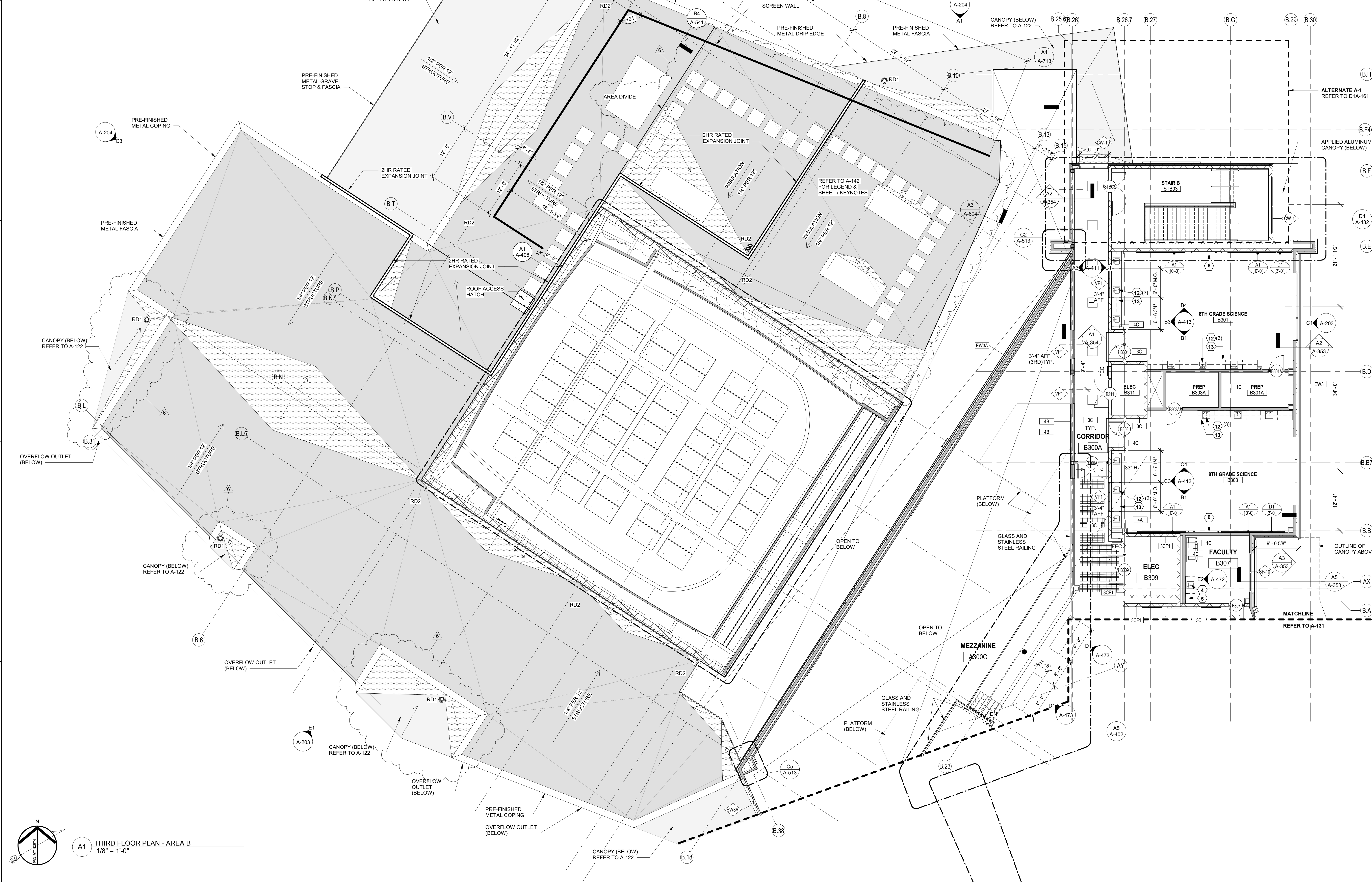

A1 THIRD FLOOR PLAN - AREA B
 1/8" = 1'-0"