

E

D

C

B

A

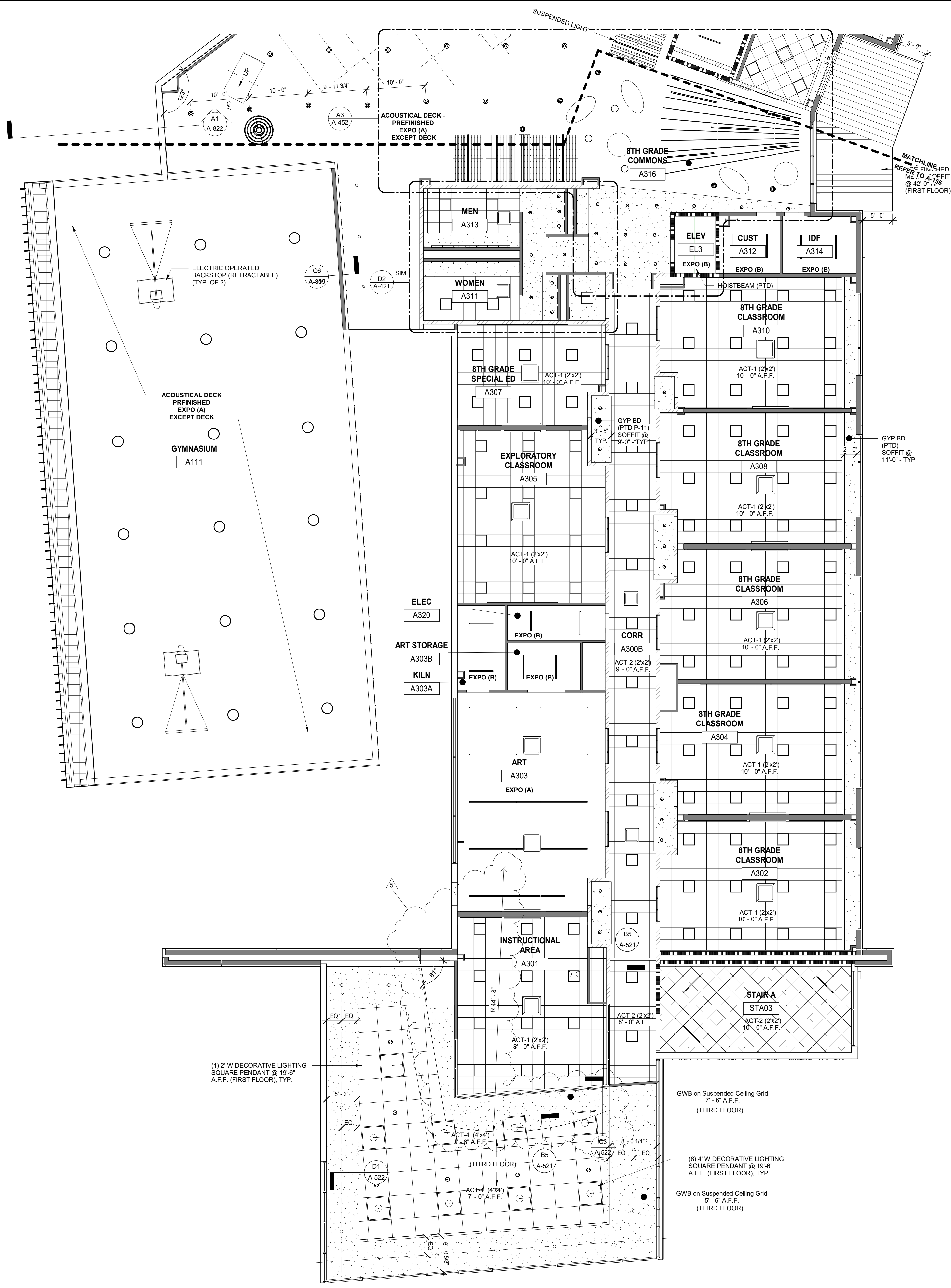

REFLECTED CEILING PLAN LEGEND			
	2x2 ACOUSTICAL TILE CLG		RECESSED DOWNLIGHT
	4x4 ACOUSTICAL TILE CLG		DECORATIVE DOME PENDANT LIGHT
	GYPSUM BOARD (PTD)		CYLINDER PENDANT LIGHT
	2x2 ACOUSTICAL METALWORKS TILE GRID		SUPPLY DIFFUSER
	2x2 CLG LIGHT FIXTURE		RETURN AIR GRILLE
	2x2 ACOUSTIC CEILING LINEAR LIGHT FIXTURE (REPLACES GRID TEE)		EXIT SIGN
	LINEAR LIGHT FIXTURE SURFACE MOUNTED (UON)		SPEAKER
	LINEAR LIGHT FIXTURE SUSPENDED		EXHAUST FAN
	DECORATIVE LIGHT FIXTURE SUSPENDED		CLG MOUNT PROJECTOR
	DECORATIVE LIGHT FIXTURE SUSPENDED		SUPPLY DIFFUSER
	DECORATIVE LIGHT FIXTURE SUSPENDED		SUSP ACOUSTIC BAFFLE (SEE SCHED FOR DETAILS)
	4 WAY CASSETTE		LINEAR METAL SOFFIT
	4x4 BARREL CEILING DIFFUSER		PAINT EXPOSED STRUCT. DUCTWORK, PIPING, CONDUIT, AND DECKING
			EXPOSED CONST ABV. NO PAINTING REQ'D

**GENERAL SHEET NOTES**

A. SEE SPECIFICATIONS FOR ACOUSTIC CEILING TILE AND GRID SUSPENSION SYSTEM TYPES.

B. ACOUSTIC CEILING TILES TO BE TYPE 1 (ACT-1), UON

C. CEILING HEIGHTS TO BE 9'-6" TYP, UON

D. (X' - X') DENOTES HEIGHT OF CEILING AFF

E. COORDINATE WITH MEP DWGS & SPECIFICATIONS FOR LIGHT FIXTURES, DIFFUSERS, GRILLES, & ANY ADDITIONAL CEILING FIXTURES.

- SHEET KEYNOTES**
- NO CEILING, PAINT EXPOSED STRUCTURE, DUCTWORK, PLUMBING, CONDUIT, AND DECKING U.N.O.
  - NO CEILING, NO PAINTING REQUIRED
  - DUCTWORK & MECHANICAL EQUIPMENT TO BE PAINTED CUSTOM COLOR.
  - ACOUSTICAL CLOUD TYPE A: ECOPHON 4'-0" DIA CIRCLE.
  - ACOUSTICAL CLOUD TYPE B: ECOPHON 3'-0" x 6'-0" OVAL.
  - NOT IN USE.
  - NOT IN USE.
  - ACOUSTICAL CLOUDS TYPE E: ECOPHON 4'-0" x 8'-0" RECTANGLE, TILTED 15 DEGREES TOWARD CEILING, REFER TO DRAWINGS FOR DIRECTION.
  - ACOUSTICAL CLOUD TYPE F: ARMSTRONG SOUNDSCAPES CANOPY ACOUSTICAL VALLEY, A6 4' x 75' RECTANGLE.
  - SUSPENDED LINEAR ACOUSTIC BAFFLES. SEE SCHEDULE ON SHEET A-615.
  - PROVIDE ACOUSTICAL SPRAY APPLIED FINISH TO BOTTOM OF DECK. COLOR TO BE SELECTED BY ARCHITECT.



1621 N. Lincoln Street  
Wilmington, DE 19806  
(P) 302.658.6426  
(F) 302.658.8431  
abhagen@ABHA.com  
www.ABHA.com

CONSULTANTS  
Davis Bowen & Friedel, Inc.  
Civil Engineer

Pilottown Engineering  
Structural Engineer

Activitas, Inc.  
Landscape Architect

GIPE Associates  
MEP Engineer

Stages  
Theater & Acoustic Consultant

Corsi Associates  
Food Service Consultant

## CONSTRUCTION DOCUMENTS

PROJECT  
NEW MIDDLE SCHOOL

910 SHIELDS AVENUE  
LEWES, DE 19958

OWNER  
CAPE HENLOPEN  
SCHOOL DISTRICT  
1270 KINGS HWY  
LEWES, DE 19585

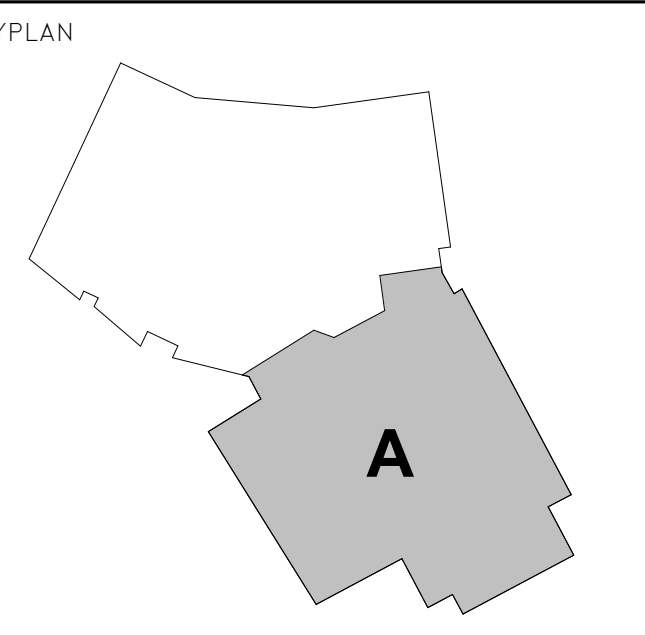

MARK	DATE	DESCRIPTION
5	08/16/2023	ASI-036 Media Center Soffit
4	04/13/2022	ADDENDUM NO. 2
3	05/17/2022	CONFORMANCE SET
2	03/18/2022	ISSUED FOR BID
1	02/04/2022	DFM FINAL REVIEW

PROJECT NUMBER: 2020-14  
FILE NAME: CHMS\_Arch\_v2020.rvt  
DRAWN BY: LR  
CHECKED BY: BTW

The professional services of ABHA Architects, Inc. are undertaken for and performed in the interest of Cape Henlopen School District. No contractual obligation is assumed by ABHA Architects, Inc. for the benefit of any other person involved in the project.

These documents are owned by ABHA Architects, Inc. and shall not be used without written permission. Copyright ABHA Architects, Inc. © 2021

SHEET TITLE  
THIRD FLOOR RCP -  
AREA 'A'

A-155

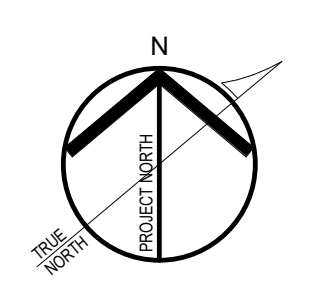

A1 RCP - 03 - THIRD FLOOR - AREA A  
1/8" = 1'-0"