



ADDENDUM NO. 1

Project: MMC – Longwood Entrance
MMC – Courtyard Fitout
MMC – Kitchen Renovations
1121 Forrest Ave.
Dover, DE 19904

Addendum Date: January 4, 2025

A. This Addendum shall be considered part of the bid documents for the above-mentioned projects as though it had been issued at the same time and shall be incorporated integrally therewith. Where provisions of the following supplementary data differ from those of the original bid documents, this Addendum shall govern and take precedence.

B. Bidders are hereby notified that they shall make any necessary adjustments in their estimates as a result of this Addendum. It will be construed that each bidder's proposal is submitted with full knowledge of all modifications and supplemental data specified herein. Receipt of this Addendum shall be noted in the space provided on page 10 of 11 of the Project Manual.

C. The Bid Documents are modified and clarified, as follows:

D. RFI No. 1 – MMC Courtyard Fitout

1. General Project Requirements Note #12- This note only pertains to the new work of this Courtyard Fitout and not the entire MMC facility. There are no plumbing fixtures
2. General Project Requirements Note #18 – Please disregard this note – There are no wood and metal surfaces to be painted
3. General Requirement Note #15 – Please disregard this note.

Phone: 302-653-3550
Cell: 302-359-3313
bill@wbjarchitect.com
www.wmbylerarchitect.com

4. A Finish Schedule will be provided in a forthcoming Addendum.
5. All existing alumn framed windows at the Courtyard Fitout will be wrapped with ¾" Azek trim boards. Details will be provided in a forthcoming addendum
6. The existing concrete slab at the MMC Courtyard Fitout will be removed in it't entirety. A new 4" thick, 3500 psi, fibermesh reinforced concrete slab with a steel trowel is to be placed. The top of the new slab is to be set flush with the top of the existing slab of the adjacent exercise room. A 6 mil poly vapor barrier is to be placed on the surface of the compacted dirt fill. Use select fill type G comcompactd to 95% incordance with ASTM D1557.

RFI No. 2 – MMC Longwood Entrance

1. Design Values: Roof Live Load – 20 PSF
 Roof Dead Load – 10 PSF
 Ground Snow Load – 25 PSF
 Floor Live Load – 125 PSF
 Deflection – L/240
 Wind Speed – 115 MPH
 Exposure – B
 Risk Cat – 1
 Construction Lumber No2 SPF, Fb 750 PSI
2. Use Simpson BCS2 – 3/6 post to beam connector cap at each 6x6 wood column
3. Detail 5/ A5 is showing a 3 ply 2x12 beam. This is not a LVL
4. Use white 0.050 aluminum for the beam and fascia wrap.
5. Use white 0.35 vinyl for the vented soffit and the solid ceiling panels.

RFI No. 3 – MMC Longwood Entrance

1. Question: Can site work drawings be bid with architectural and MEP drawings as one bid?
 Answer: No the bid form separates these as different line items.
2. Note E11 on drawing A4 is to be eliminated
3. On drawing D1 revise note D11 to read...."Existing painted drywall ceiling is to remain." There is no suspended acoustical ceiling in these spaces.
4. Question – On drawing C-04 what size is the grease trap line and what type of pipe is required?

Answer: The existing grease trap line sizes were not surveyed. It is safe to say that the line will be no greater than 6", and should be an SDR-35 pipe material or similar that is used for sanitary sewer

RFI No. 4 – MMC Kitchen Renovations

1. See attached 40 & 60 gal steam kettle specifications. The specifications for the 12 gal tilt kettle are forthcoming.
2. See Detail 4/A1 for SS floor drain pan construction

MMC Kitchen Renovations – Pre Bid Meeting

1. Pre Bid Meeting question: To avoid a second roof penetration can the new exhaust hood duct be attached to the adjacent existing exhaust hood duct and the existing exhaust fan be upsized?

Answer: No. Each exhaust system needs to function independently for better control when in use.

2. Pre Bid Meeting question: What floor tile is to be used at the cut for the new sanitary line

Answer: When making the concrete floor repair for the new sanitary line the new floor tile used at the cut is to match the existing quarry tile flooring size and color.

Sincerely

William Byler Jr. – Architect

Cc: All Bidders of Record
T. Adams – MMC
J. Tribbet – MMC

Attachments: 40 & 60 gal kettle specifications

End of Addendum No. 1

GLOBE Equipment Company

300 Dewey Street • Bridgeport, CT 06605 • 203.367.6611 • 203.366.7003 (fax) • GlobeEquipment.com

Project:

Modern Maturity Center 480/3ph
Mark Biggs
1121 Forrest Ave
Dover, DE 19904

From:

Globe Equipment Company
Natalie Sanabria
300 Dewey Street
Bridgeport, CT 06605
(203) 367-6611

Project Code: 41352

Item	Qty	Description
1	1 ea	KETTLE, ELECTRIC, STATIONARY Groen Model No. EE-40 Kettle, electric, 40-gallon capacity, 2/3 jacket, 316 stainless steel liner, insulated & sheathed, open tri-leg base, stainless steel construction, 2" TDO, 1/4" perforated strainer & hinged cover, bullet feet, 30 PSI Dimensions 37(h) x 38.13(w) x 43.75(d)
2	1 ea	KETTLE, ELECTRIC, STATIONARY Groen Model No. EE-60 Kettle, electric, 60-gallon capacity, 2/3 jacket, 316 stainless steel liner, insulated & sheathed, open tri-leg base, stainless steel construction, 2" TDO, 1/4" perforated strainer & power aid cover, bullet feet, 30 PSI Dimensions 40(h) x 42.13(w) x 42.75(d)





Floor Kettles model EE

Description

Kettle shall be a Groen Model EE (Specify 20, 40, 60, 80 or 100 gallon) stainless steel, self-contained, steam jacketed unit operating from an electric heated steam source contained within unit.

Construction

Kettle proper shall be of type 316 stainless steel, solid one-piece welded construction. All exposed surfaces shall be stainless steel. All controls shall be contained within the cabinet.

Kettle body is sheathed in stainless steel and air gap insulated. Faucet mounting bracket is standard.

Finish

Interior of kettle shall be polished to a 180 emery grit finish. Exterior of kettle shall be finished to a #3 finish, ensuring maximum ease in cleaning and maintaining brilliant appearance.

ASME Code and UL Listing

Unit shall be ASME shop inspected, stamped and registered with the National Board for operation up to a maximum working pressure of 30 PSI. Unit shall be UL listed for sale in USA and Canada. Unit shall be registered in Canada with a CRN number.

Sanitation

Unit shall be designed and constructed to meet NSF and known health department and sanitation codes, and be NSF listed.

Drawoff

Unit shall have a 2" sanitary tangent drawoff with a 316 stainless steel compression disk drain valve for easy disassembly without tools. Larger 3" drawoff available. The drain outlet shall be equipped with a removable 1/4" perforated stainless steel strainer.

Cover

Cover shall be a one-piece, hinged design dome cover on units up to 40 gallons. 60-100-gallon units shall have a one-piece domed cover with No. 51 counter balanced spring-assisted actuator.

Controls

All controls shall be contained in a stainless steel enclosure within easy reach of the operator. Controls include a thermostat, pilot light, pressure/vacuum gauge, contactor, water level sight glass, safety valve and low water cut-off.

Self-Contained Steam Source

Kettle shall have an electric, self-contained steam source to provide kettle temperatures from 150 to approximately 270°F. Unit shall be factory charged with chemically-pure water and rust inhibitors to ensure long life and minimum maintenance.

Model EE-40 shown

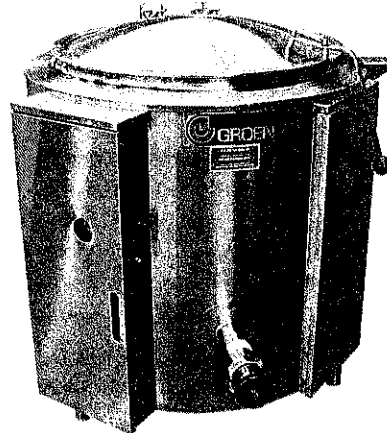

Performance

Unit to be thermostatically controlled to shut off automatically when desired temperature is reached and turn on when product temperature falls below desired setting. Outer sheathing and air insulating gap retains heat and keeps kettle exterior cooler to the touch.

Installation

Unit requires single electrical connection. Specify 208, 240, or 480 Volt, three phase, 50 or 60 HZ. 20 and 40 gallon models available in single phase.

Options/Accessories

- 3" tangent drawoff valve with
- 1/4" perforated disk strainer
- 1/8" perforated disk strainer
- 1/4" perforated disk strainer
- Solid disk strainer
- Basket inserts (TRI-BC)
- Swing faucets
- Automatic water filler
- Kettle brush kit
- Contour measuring strip
- Gallon etch marks
- Single Phase Terminal Block Kit

Origin of Manufacture

Kettle shall be designed and manufactured in the United States.

**Stainless Steel
Steam Jacketed
Kettle**

**Floor Mounted,
Stationary,
Self-Contained
Electric Heated
20, 40, 60, 80 or 100-
Gallon Capacity**

Short Form

Groen Model EE (Specify 20, 40, 60, 80, 100 gallons) self-contained, electric heated, stainless steel, steam jacketed kettle, UL and NSF listed, ASME code constructed and National Board registered for operation up to 30 PSI. Automatic thermostat control and pressure gauge mounted in convenient stainless steel control housing. Insulation outer sheathing, 2" tangent drawoff and hinged cover standard. Single electrical connection required: specify Voltage Phase/Hz. Made in USA.



Applications

Meat Dishes
Vegetables
Soups
Sauces
Pasta
Rice
Pie Fillings
Gravies
Poultry
Seafood

TABLE OF DIMENSIONS

CAPACITY (GALLONS/LITRES)

DIM'S.	40/752				60/238				80/304				100/380			
	IN.	MM	IN.	MM	IN.	MM	IN.	MM	IN.	MM	IN.	MM	IN.	MM		
A	20	508	26	660	30	762	32	813	32	813	32	813	32	813		
B	24	610	30	762	34	864	36	914	36	914	36	914	36	914		
C	26	660	32	813	36	914	38	965	38	965	38	965	38	965		
D	21-3/4	552	24-3/4	620	26-3/4	679	27-3/4	705	27-3/4	705	27-3/4	705	27-3/4	705		
E	13	330	10	254	10	254	10	254	10	254	10	254	10	254		
F	9	229	6	152	6	152	6	152	6	152	6	152	6	152		
G	37	940	37	940	40	1016	44	1118	50	1270	50	1270	50	1270		
H	60	1524	66	1676	68	1727	74	1879	80	2032	80	2032	80	2032		
J	16	406	12	305	12	305	12	305	12	305	12	305	12	305		
K	18	457	23	584	22	559	23	584	23	584	23	584	23	584		
L	24-1/8	616	24-1/8	616	24-1/8	616	24-1/8	616	24-1/8	616	24-1/8	616	24-1/8	616		
M	15	381	11	279	11	279	11	279	11	279	11	279	11	279		
N	17-3/4	451	20-3/4	527	22-3/4	578	23-3/4	603	23-3/4	603	23-3/4	603	23-3/4	603		

ELECTRICAL TABLE

KETTLE MODEL	208V/3PH			240V/3PH			480V/3PH		
	KW	AMP	KVA	KW	AMP	KVA	KW	AMP	KVA
EE-20	10.8	30	12	29	12	29	12	14	14
EE-40	21.6	60	24	58	24	28	24	28	28
EE-60	32.4	95	36	87	36	44	36	44	44
EE-80	32.4	95	36	87	36	44	36	44	44
EE-100	32.4	95	36	87	36	44	36	44	44

- ELECTRICAL NOTES:
- OTHER VOLTAGES ARE AVAILABLE ON MOST MODELS.
 - SINGLE PHASE OPERATION AVAILABLE ON 20 & 40 GAL. KETTLES ONLY.
 - USE KIT 170960 IF SWITCHING 3 PHASE TO 1 PHASE.

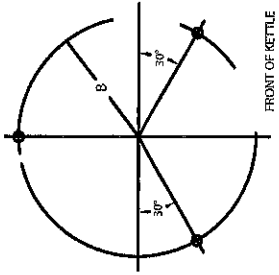

PLAN VIEW OF LEGS

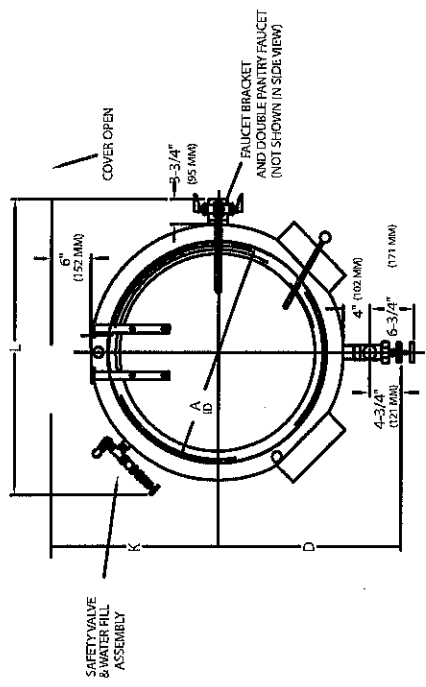

- NOTES:
- MODEL #51 COUNTERBALANCED COVER FURNISHED ON 60, 80 & 100 GAL. SIZES ONLY.
 - MODEL #41 COVER (SHOWN) IS STANDARD ON 20 & 40 GAL. SIZE.
 - SINGLE DOUBLE PANTRY FAUCETS - OPTIONAL.
 - 3" TANGENT DRAW-OFF VALVE - OPTIONAL.

