



Richard Y. Johnson & Son, Inc.

General Contractors & Construction Managers

Serving Delaware Since 1946

www.ryjson.com

18404 Johnson Rd
PO Box 105
Lincoln, DE 19960
Phone 302-422-3732
Fax 302-422-4696

**Delmarva Christian School
21777 Sussex Pines Road, Georgetown, Delaware
Bid Pac A– Contracts 1 thru 18
April 28, 2025**

Addendum No. 2

Attention all Prospective Bidders:

The following clarifications, changes and /or additions shall by this reference be incorporated into the contract documents as though dully set forth therein.

Addendum No. 2 consists of:
RYJ Written directive (3 pages)
Drawing Sketch G104 (1 Drawing)

Non – Technical Specifications

Section 004126 - Bid Form

1. Delete Non-Collusion Statement, not required with bid submission.
2. A bid bond is not required for this project.

Section 011100 Summary of Work

Contract 1 Site Work

Page 011100-9; Add Paragraph PPP “PPP. This contract is required to have the owner parking area stoned and base paved along with the fire lane prior August 15, 2025; reference Drawing G104 in Addendum 2 for clarification.”

Bidders Questions + Clarification

RFI No. Description

RFI 01

Question 1:

Contract 1-Sitework, Scope of Work item Y, states to provide exterior caulking of expansion joints at all concrete locations including sidewalks and curbs. Note 2, states, concrete sidewalks shall be constructed per DelDOT specifications. DelDOT does not require caulking of expansion joints, please advise.

Answer 1:

Provide per DelDOT specifications.

Question 2:

Scope of Work Items DD., JJ., and LL. Appear to contradict each other. Will RYJ be providing CCR reports and all testing and inspections for site work?

Answer 2:

Delete Item JJ. In site work Scope of Work. Provide all required testing and CCR reports.

Question 3:

Scope of work Item NN. Our fencing subcontractor is asking for more information and details on the dumpster enclosure fencing/gates.

Answer 3:

See Keynote S27 and Details 10 & 13/CS6001.

RFI 02

Question 1:

Which Contract is responsible for the exterior 5/8" wood sheathing on walls?

Answer 1:

Contract 9- Drywall/Metal Stud

Question 2:

Which contractor is responsible for wall tile?

Answer 2:

Contract 11- Floor Covering Work

Question 3:

On Drawing A605 it mentions Doors 165C Q-4 location circulation. Where and what floor plan are they shown?

Answer 3:

See detail 5/A605. They are in wall between existing building and new construction.

Question 4:

Does Trade need to provide dumpsters or is there job site dumpsters provided?

Answer 4:

Job site dumpsters will be provided.

Question 5:

Contract 5- Carpentry list items G, H, and I as to provide wood blocking as required to install items. But details on A501 call out metal blocking to be used, please clarify.

Answer 5:

Either type of blocking may be used.

Question 6:

Contract 5 Carpentry Item T-provide wood blocking for roof top mechanical. M501 shows no wood detail to roof. Please clarify detail drawing such.

Answer 6:

Provide blocking where indicated on details.

Question 7:

Can you clarify which contract is to carry the stainless steel corner protection for the Cornell Roll Down doors?

Answer 7:

Contract 5, Item QQ

RFI 03

Question 1:

For Contract 14-Food Service Equipment we do not see plans or specs?

Answer 1:

Please see drawing A403 for Prep Room equipment. There are no specifications.

RFI 04

Question 1:

Can the AWI certification requirements be waived.

Answer 1:

Yes, AWI Certification is not required.

RFI 05

Question 1:

Finish notes on finish legend indicate that all flooring materials are to be ordered from "Cornerstone Building Supply", is this correct?

Answer 1:

No, delete all references to "Cornerstone Building Supply" from documents. Materials may be purchased from any appropriate supplier/vendor.

End of Addendum No. 2

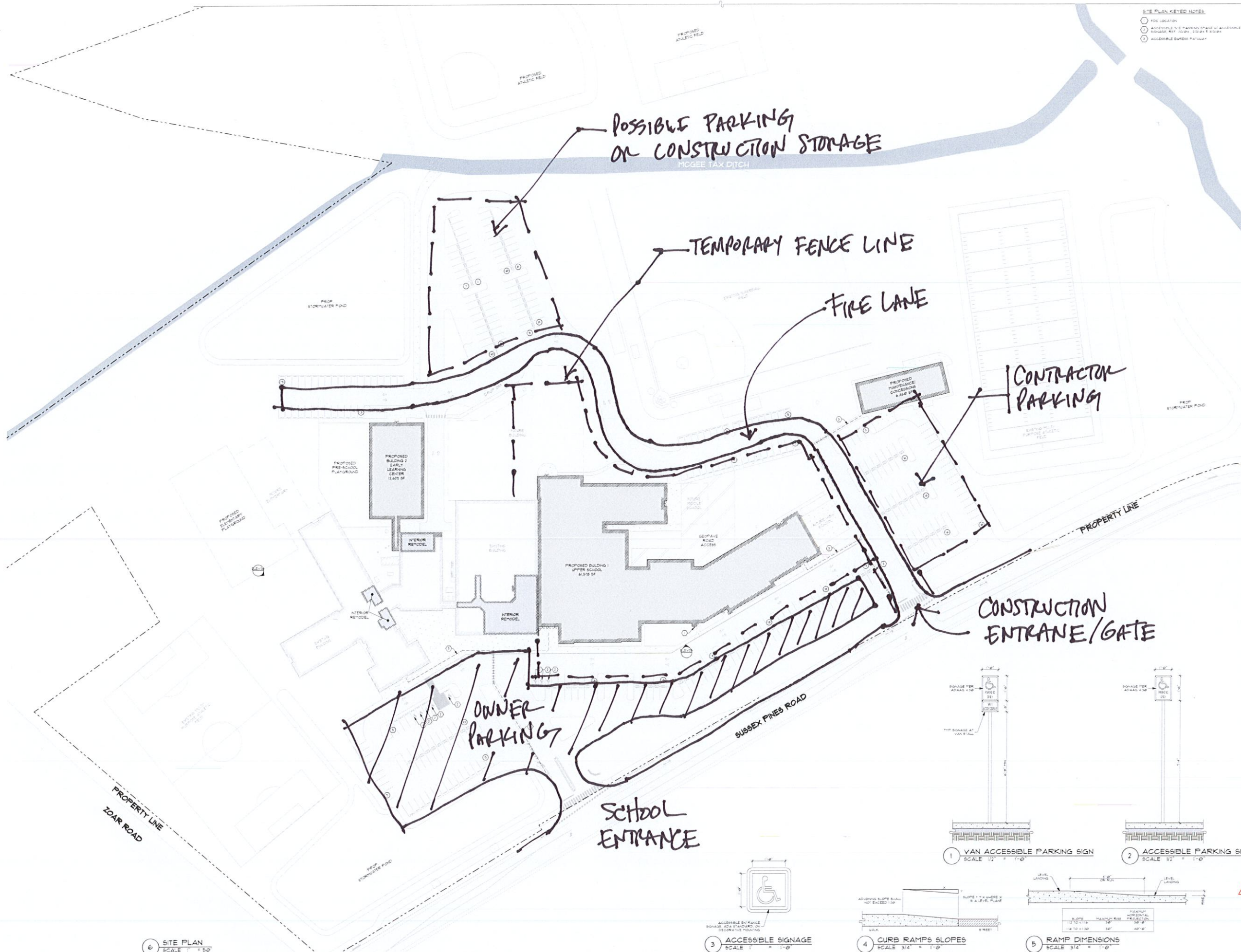

- SITE PLAN KEYED NOTES**
- 1. XDC LOCATION
 - 2. ACCESSIBLE SITE PARKING SPACE UP ACCESSIBLE
 - 3. ACCESSIBLE BUS/STATION
 - 4. ACCESSIBLE BUS/STATION

BGWARCHITECTS
Innovative design. Stewardship driven.

PROJECT: DELMARVA CHRISTIAN SCHOOL
UPPER SCHOOL ADDITION
2111 SUSSEX PINES RD
GEORGETOWN, DE 19341

REV.	DATE	DESCRIPTION
01	11/20/2024	ORIGINAL

PROJECT: DELMARVA CHRISTIAN SCHOOL
UPPER SCHOOL ADDITION
2111 SUSSEX PINES RD
GEORGETOWN, DE 19341

PROJECT: DELMARVA CHRISTIAN SCHOOL
UPPER SCHOOL ADDITION
2111 SUSSEX PINES RD
GEORGETOWN, DE 19341

SHEET TITLE: ACCESSIBLE SITE PLAN
SHEET NUMBER: 1

G104
DO NOT SCALE DRAWING