

### INfiltration BASIN 1 SEQUENCE OF CONSTRUCTION

1. NOTIFY DNREC, GEO-TECHNICAL ENGINEER OF RECORD AND THIRD PARTY CCR OF INTENT TO BEGIN CONSTRUCTION.
2. BMP CONSTRUCTION REVIEW WITH CONTRACTOR, GEO-TECHNICAL ENGINEER, THIRD PARTY CCR AND DNREC INSPECTOR TO DISCUSS HOW EQUIPMENT SHOULD BE UTILIZED TO AVOID FACILITY COMPACTION.
3. THIRD PARTY CCR OR GEO-TECHNICAL ENGINEER / SOIL SCIENTIST TO CONDUCT CONSTRUCTION REVIEWS, INCLUDING PICTURES, OF:
  - 3.1. EXCAVATION AND GRADING INCLUDING INTERIM AND FINAL ELEVATIONS.
  - 3.2. OBSERVATION OF INFILTRATION SURFACE AND INFILTRATION PRACTICE VERIFICATION CHECKLIST TO BE COMPLETED.
  - 3.3. STABILIZE BOTTOM AND SIDE SLOPES WITH PERMANENT SEED MIX #4 AS SHOWN ON STANDARD DETAIL ON SHEET C-405.
  - 3.4. GEO-TECHNICAL ENGINEER / SOIL SCIENTIST OF RECORD TO BE PRESENT DURING THE COMPLETE CONSTRUCTION OF POND FOR OVERSIGHT, VERIFICATION THAT THE SOIL PROFILE IS CONSISTENT WITH THE PROJECT SOILS REPORT, AND DIRECT REMOVAL / UNDERCUTTING OF MATERIAL AS NECESSARY.
4. EXCAVATION TO BE PERFORMED BY BACKHOE FROM OUTSIDE FACILITY TOP OF BANK. THE PREFERRED METHODOLOGY IS FOR THE BACKHOE TO BEGIN FROM END OF FACILITY AND EXCAVATE TO PERMANENT FACILITY BOTTOM AS IT BACKS OUT SO AS NOT TO TRAVERSE BOTTOM OR SIDE SLOPES.
5. (ALT 1) 15" OUTFALL PIPE ONLY TO BE INSTALLED IF INFILTRATION RATES ARE LESS THAN DESIGN RATES.
6. PERFORM CONFIRMATORY TESTING OF THE NATIVE SOILS INFILTRATION RATE AND SEPARATION OF FACILITY BOTTOM FROM SEASONAL HIGH GROUNDWATER OF THE FACILITY SHALL BE VERIFIED PER SIP GUIDELINES ONCE EXCAVATION IS COMPLETE. NOTIFY DESIGN ENGINEER AND DNREC SITE INSPECTOR IF THE CONFIRMATORY RATES DO NOT MEET REGULATIONS.
7. THE DNREC SITE INSPECTOR TO PERFORM FINAL CONSTRUCTION REVIEW INCLUDING DEVELOPMENT OF A PUNCH LIST FOR FACILITY ACCEPTANCE.
8. BEFORE PROJECT COMPLETION, OWNER SHALL SUBMIT A FINAL POST CONSTRUCTION OPERATION & MAINTENANCE PLAN.

### OPERATION AND MAINTENANCE NOTES

1. THE DNREC SEDIMENT AND STORMWATER PROGRAM RESERVES THE RIGHT TO ENTER PRIVATE PROPERTY FOR PURPOSES OF PERIODIC SITE REVIEWS.
2. THE DNREC SEDIMENT AND STORMWATER PROGRAM SHOULD BE NOTIFIED WITHIN 30 BUSINESS DAYS IF THE PROPERTY OWNERSHIP IS TRANSFERRED TO A NEW PERSON OR ENTITY.
3. THE DNREC SEDIMENT AND STORMWATER PROGRAM MAY SEEK ENFORCEMENT ACTION AGAINST ANY OWNER DEEMED NEGLIGENT IN FULFILLING THE OPERATION AND MAINTENANCE REQUIREMENTS OF THE DELAWARE SEDIMENT AND STORMWATER REGULATIONS.
4. THE DNREC SEDIMENT AND STORMWATER PROGRAM SHOULD BE CONTACTED IF A CONCERN ARISES REGARDING A STORMWATER MANAGEMENT FACILITY, BEFORE ANY NON-ROUTINE MAINTENANCE, OR IF MODIFICATIONS TO THE FACILITY ARE DESIRED.
5. ANY DESIGN MODIFICATIONS MADE TO THE STORMWATER SYSTEM SHALL REQUIRE THE CREATION OF A NEW POST CONSTRUCTION STORMWATER MANAGEMENT PLAN AND/OR OPERATIONS AND MAINTENANCE PLAN, WITH APPROVAL OF THE PLANS BY THE DNREC SEDIMENT AND STORMWATER PROGRAM.
6. FOR ALL STORMWATER EASEMENT AREAS (I.E., ACCESS, MAINTENANCE, OR OFFSITE) AND THE MINIMUM 15-FOOT ACCESSWAYS TO ALL STORMWATER FACILITIES AND THEIR STRUCTURAL COMPONENTS, REGULAR MOWING SHOULD BE PERFORMED TO KEEP THE GRASS 6 INCHES OR LESS; NO TREES OR SHRUBS SHOULD BE PLANTED, AND ANY FOUND GROWING SHOULD BE REMOVED; AND NO PERMANENT STRUCTURES, SUCH AS FENCES OR SHEDS, SHOULD BE LOCATED WITHIN THE EASEMENT OR ACCESSWAY.
7. TREES SHOULD NOT BE PLANTED, AND SHOULD BE REMOVED IF FOUND GROWING, ON AND WITHIN 15 FEET OF ALL POND EMBANKMENTS, ON POND SLOPES OR SAFETY BENCHES, AND WITHIN 10 FEET OF STRUCTURAL COMPONENTS, SUCH AS PIPE INLETS.
8. WHEN THE FACILITY IS EXCAVATED TO REMOVE ACCUMULATED SEDIMENT, THE DISPOSAL AREA SHALL BE PERMANENTLY STABILIZED SO THAT IT DOES NOT RECREATE AN EROSION PROBLEM. ANY MATERIAL TAKEN OFFSITE SHALL STILL BE USED OR DISPOSED OF IN AN APPROVED DNREC MANNER.
9. THE ACCUMULATED SEDIMENT REMOVED FROM THE FACILITY DURING MAINTENANCE SHALL BE HAULED OFFSITE.
10. BEFORE ANY EARTHWORK OR EXCAVATION TAKES PLACE, THE CONTRACTOR SHOULD CALL MISS UTILITY AT 811 OR 1-800-282-8555 AT LEAST 48 HOURS PRIOR TO CONSTRUCTION, TO HAVE ALL EXISTING UTILITIES MARKED ONSITE.

LABEL	SIZE (IN.)	TYPE	INVERT (FT.)
FE-100	15	RCP-III	66.25

LABEL	DESCRIPTION						INVERT ELEVATION		
	FROM	TO	SIZE (")	TYPE	LENGTH	CLASS	SLOPE	UP	DOWN
P100	FES 100	EX INLET	15"	RCP	258'	III	0.87%	66.25	64.00

Maintenance Activity	Schedule
• Replace topsoil and top surface filter fabric (when clogged). • Mow vegetated filter strips as necessary and remove the clippings.	As needed
• Ensure that the contributing drainage area, inlets, and facility surface are clear of debris. • Ensure that the contributing drainage area is stabilized. Perform spot-seeding if where needed. • Remove sediment and oil/grease from inlets, pretreatment devices, flow diversion structures, and overflow structures. • Repair undercut and eroded areas at inflow and outflow structures.	Quarterly
• Inspect pretreatment devices and diversion structures for sediment build-up and structural damage. • Remove trees that start to grow in the vicinity of the infiltration facility that may drop leaf litter, fruits and other vegetative materials that could clog the infiltration device.	Semi-annual inspection
• Clean out accumulated sediments from the pretreatment cell.	Annually

**DAVIS BOWEN & FRIEDEL, INC.**  
ARCHITECTS • ENGINEERS • SURVEYORS  
MILFORD, DELAWARE 19966  
BALTIMORE, MARYLAND 21201  
410.770.7474

**DELAWARE VETERANS CEMETERY  
COLUMBARIUM EXPANSION  
PENCADER HUNDRED  
BEAR, NEW CASTLE COUNTY, DELAWARE**

NO.	DATE	COMMENTS
1	02/13/2026	ADDRESS DNREC COMMENTS

Date: JANUARY 2026  
Scale: AS SHOWN  
Dwn By: CLB  
Proj No.: 0586B065.B01

**SSM POST CONSTRUCTION PLAN**

Dwg No.: **C-409**

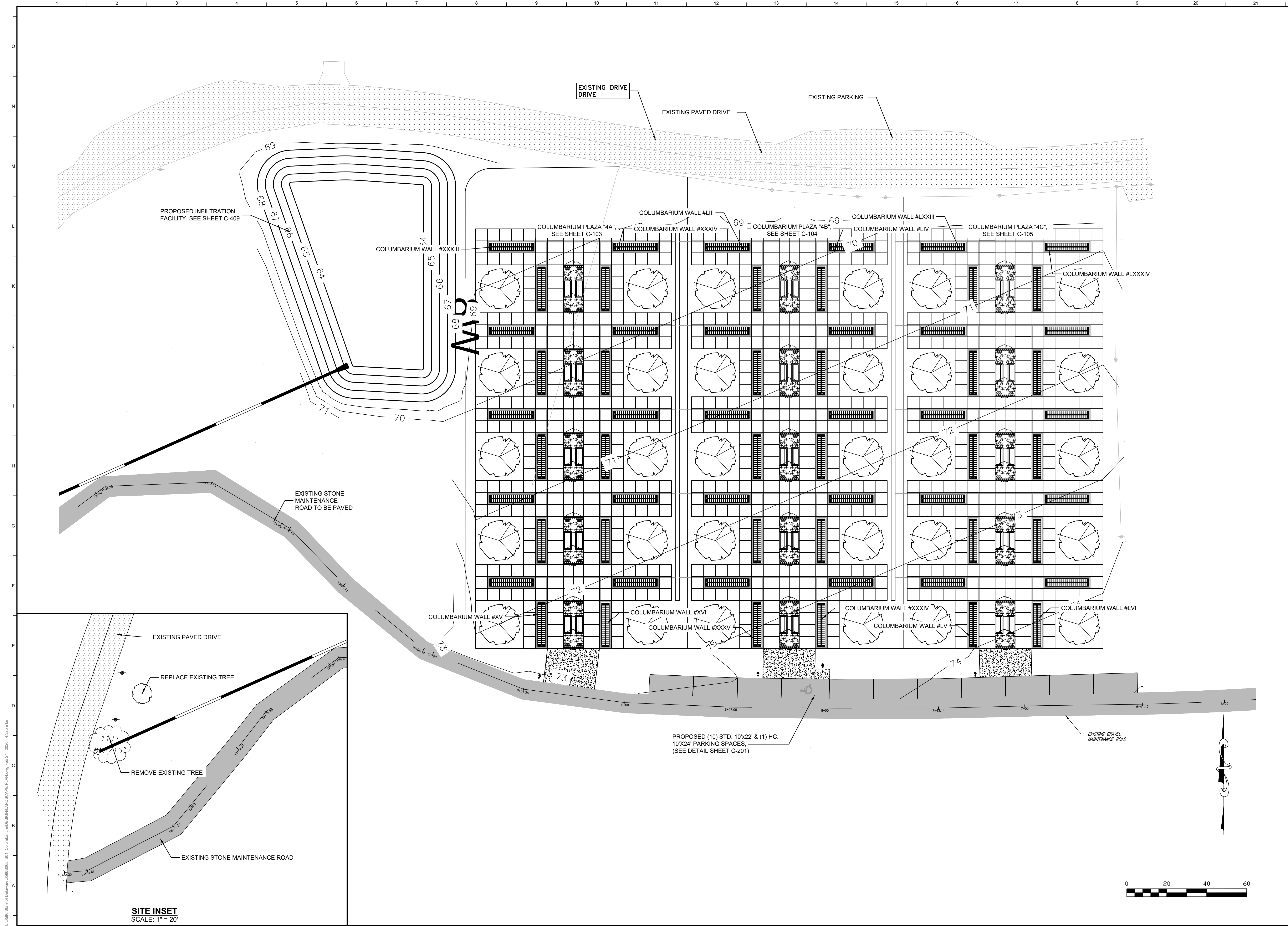

**SITE INSET**  
SCALE: 1" = 20'

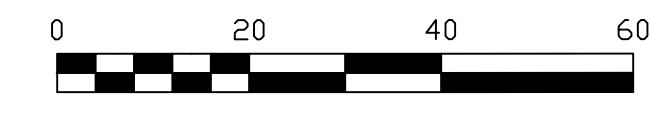

**DAVIS BOWEN & FRIEDEL, INC.**  
ARCHITECTS • ENGINEERS • SURVEYORS  
MILFORD, DELAWARE 19966  
BALTIMORE, MARYLAND 21201  
410.761.1411

**DELAWARE VETERANS CEMETERY**  
**COLUMBARIUM EXPANSION**  
PENCADER HUNDRED  
BEAR, NEW CASTLE COUNTY, DELAWARE

DATE	COMMENTS
02/17/2026	ADDRESS DFM COMMENTS

Date: JANUARY 2026  
Scale: 1"=20'  
Dwn By: KMV  
Proj No.: 0586B065.B01

**LANDSCAPE PLAN**

Dwg No.: **L-101**